



113 Tottington Road, Bury

Bury

£160,000



113 Tottington Road

Bury

Two double bedrooms, large modern bathroom, bright lounge, kitchen/diner, garden front, private rear yard, driveway parking. Close to amenities, transport links, and well-rated schools.

Council Tax band: A

Tenure: Leasehold

EPC Energy Efficiency Rating: D

EPC Environmental Impact Rating: D

- Attractive garden-fronted two-bedroom terrace with gated driveway parking
- Entrance vestibule, living room & kitchen/diner
- Two double bedrooms & large bathroom
- Private, low maintenance rear yard with fencing and access to rear driveway parking
- Off-road driveway parking, or potential as an additional private garden area
- Convenient Bury position places the home close to Bury town centre, Tottington Village and a wide range of everyday amenities
- Strong local links include nearby schools, bus routes and commuter connections to Bolton, Ramsbottom and Manchester
- Ideal first-time buyer opportunity thanks to its move-in-ready condition and practical layout
- Standout value combining space, location, lifestyle convenience and rare parking to create a compelling home in this part of Bury





GROUND FLOOR
338 sq.ft. (31.4 sq.m.) approx.

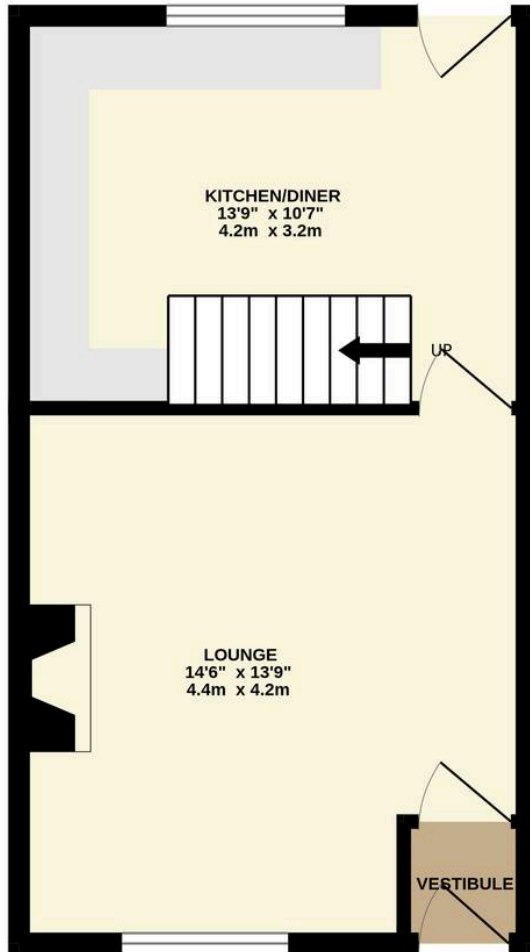

1ST FLOOR
338 sq.ft. (31.4 sq.m.) approx.

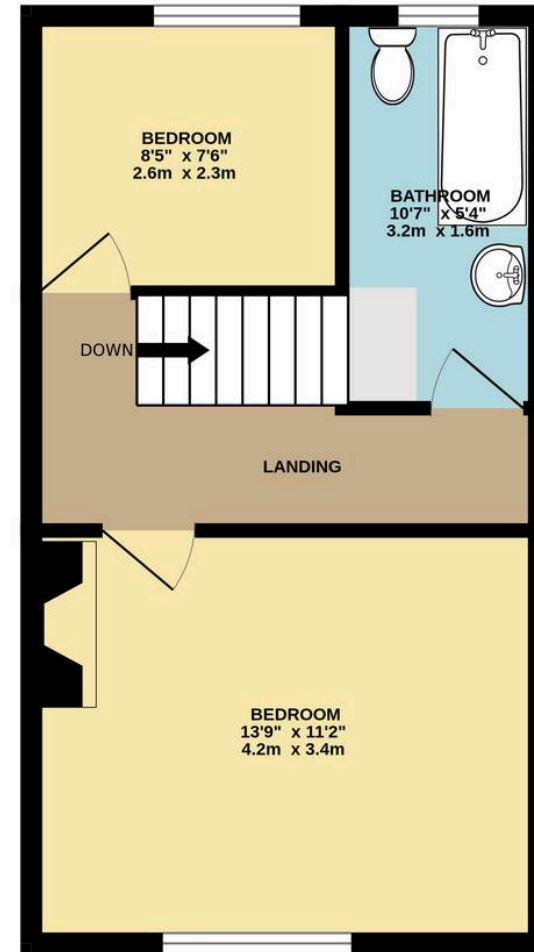

TOTAL FLOOR AREA : 676 sq.ft. (62.8 sq.m.) approx.

Whilst every attempt has been made to ensure the accuracy of the floorplan contained here, measurements of doors, windows, rooms and any other items are approximate and no responsibility is taken for any error, omission or mis-statement. This plan is for illustrative purposes only and should be used as such by any prospective purchaser. The services, systems and appliances shown have not been tested and no guarantee as to their operability or efficiency can be given.
Made with Metropix ©2026



HARRISON ESTATE AGENTS

Harrison Estate Agents, 10 Bolton Street - BL9 0LQ

0161 797 8616

info@harrison-estates.co.uk

www.harrison-estates.co.uk