



12 Sherwood Avenue, Radcliffe

Manchester

£279,950



12 Sherwood Avenue

Radcliffe, Manchester

Traditional 3-bed semi in Three Arrows with woodland views, decked garden area, open-plan lounge, modern bathroom, driveway, garage, no onward chain. Close to amenities and transport links.

Council Tax band: D

Tenure: Leasehold

EPC Energy Efficiency Rating: D

EPC Environmental Impact Rating:

- Traditional Semi Detached House with 3 Bedrooms
- Set in a Highly Desirable Three Arrows location with Starling Woods to the rear
- Decked rear garden with attractive woodland aspect
- Spacious paved driveway, detached garage
- Entrance hall, fitted kitchen, open plan lounge/dining room
- Modern Spacious white 4 piece family bathroom suite
- Close to local bus routes & access for Bury & Bolton town centres
- Offered with No Chain viewings are Highly Recommended





GROUND FLOOR



1ST FLOOR

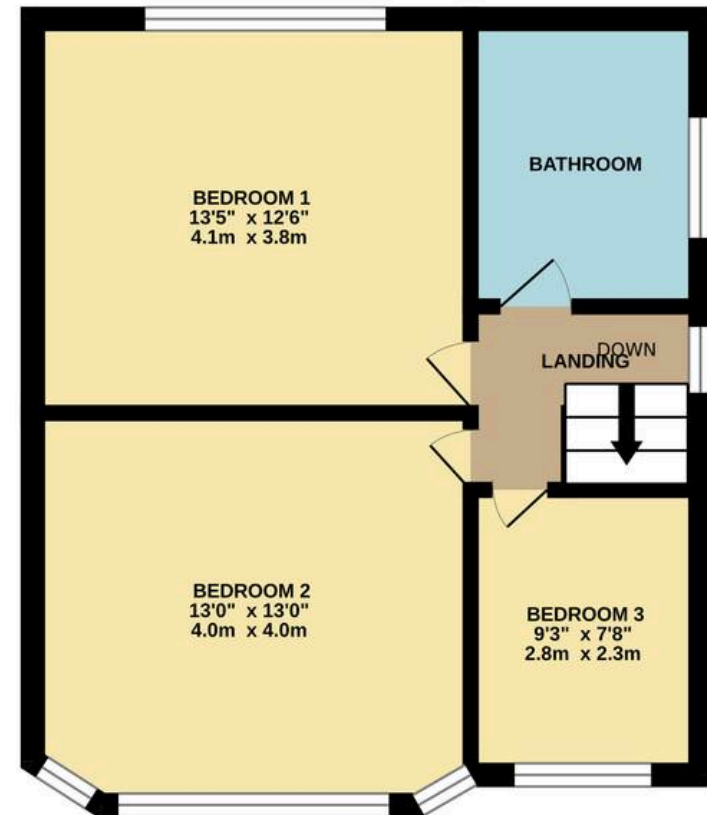



HARRISON ESTATE AGENTS

Harrison Estate Agents, 10 Bolton Street - BL9 0LQ

0161 797 8616

info@harrison-estates.co.uk

www.harrison-estates.co.uk