



4 Harcles Drive, Ramsbottom

Bury

£249,950



4 Harcles Drive

Ramsbottom, Bury

Mature semi-detached bungalow with 2 double bedrooms, garage, driveway, and gardens. Scope to modernise or extend. Prime Ramsbottom location near schools, amenities, and transport links.

Council Tax band: C

Tenure: Freehold

EPC Energy Efficiency Rating: D

EPC Environmental Impact Rating:

- Mature semi-detached bungalow in the prime residential location of Holcombe Brook
- Entrance vestibule leading into a practical hallway layout
- Spacious lounge offering comfortable living space
- Fitted kitchen with access to a small utility room
- Two well-proportioned double bedrooms
- White bathroom suite with over-bath shower
- Detached garage and generous driveway providing ample parking
- Low-maintenance level garden to the rear
- Available with no onward chain and superb potential for improvement
- Situated in Ramsbottom close to local amenities, well-regarded schools, transport links and ideal for buyers seeking a bungalow on the flat

GROUND FLOOR
638 sq.ft. (59.3 sq.m.) approx.

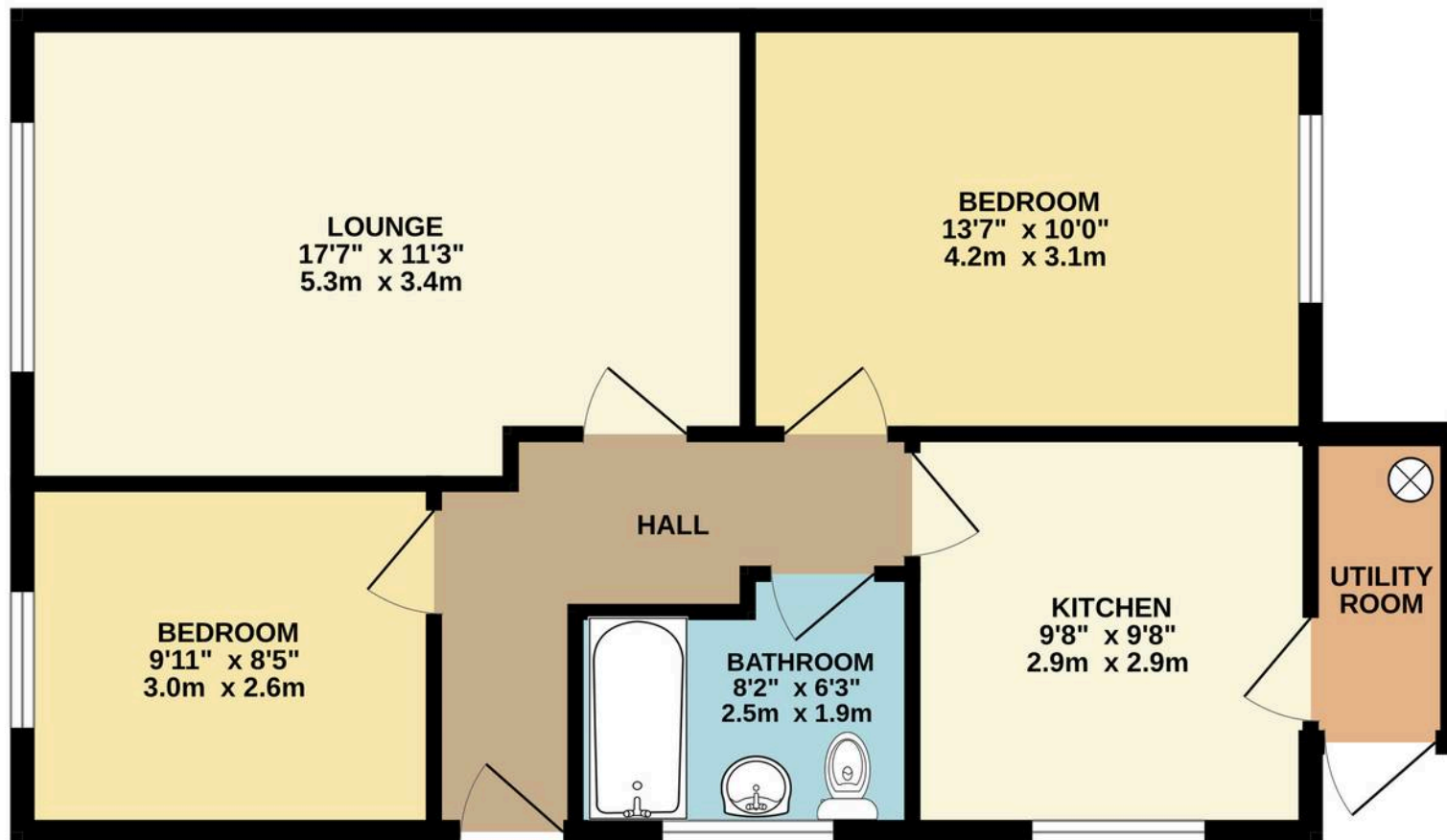

TOTAL FLOOR AREA : 638 sq.ft. (59.3 sq.m.) approx.

Whilst every attempt has been made to ensure the accuracy of the floorplan contained here, measurements of doors, windows, rooms and any other items are approximate and no responsibility is taken for any error, omission or mis-statement. This plan is for illustrative purposes only and should be used as such by any prospective purchaser. The services, systems and appliances shown have not been tested and no guarantee as to their operability or efficiency can be given.
Made with Metropix ©2025

