



181 Wash Lane, Bury

Bury

£154,950



181 Wash Lane

Bury, Bury

Council Tax band: A

Tenure: Leasehold

EPC Energy Efficiency Rating: D

EPC Environmental Impact Rating:

- 2 bedroom terrace in prime location
- Extremely convenient transport links onto M60, M66, M56 and bus routes
- Large lounge with character bay window
- Spacious open plan contemporary kitchen extension with open plan kitchen/diner aspect
- 2 double bedrooms upstairs
- Modern bathroom with character tiling and white 3 piece suite
- Attic hatch with loft ladder for additional storage
- Local to highly regarded primary and high schools

GROUND FLOOR
594 sq.ft. (55.1 sq.m.) approx.

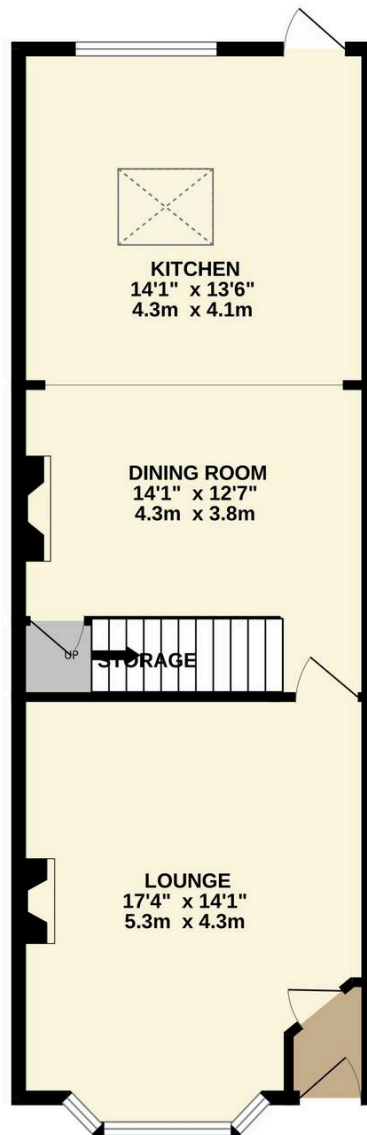

1ST FLOOR
403 sq.ft. (37.5 sq.m.) approx.

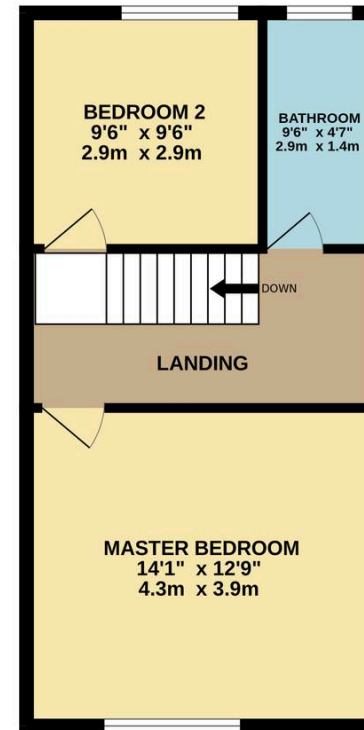

TOTAL FLOOR AREA: 997 sq.ft. (92.6 sq.m.) approx.

Whilst every attempt has been made to ensure the accuracy of the floorplan contained here, measurements of doors, windows, rooms and any other items are approximate and no responsibility is taken for any error, omission or mis-statement. This plan is for illustrative purposes only and should be used as such by any prospective purchaser. The services, systems and appliances shown have not been tested and no guarantee as to their operability or efficiency can be given.
Made with Metropix ©2025

