



10 Chiltern Drive, Bury

Bury

Offers Over £200,000



10 Chiltern Drive

Bury, Bury

Council Tax band: C

Tenure: Leasehold

EPC Energy Efficiency Rating: D

EPC Environmental Impact Rating:

- 2 Bedroom Semi-Detached Bungalow
- Popular Walshaw Park Estate
- Offered with No Onward Chain
- Full renovation required

GROUND FLOOR
712 sq.ft. (66.2 sq.m.) approx.

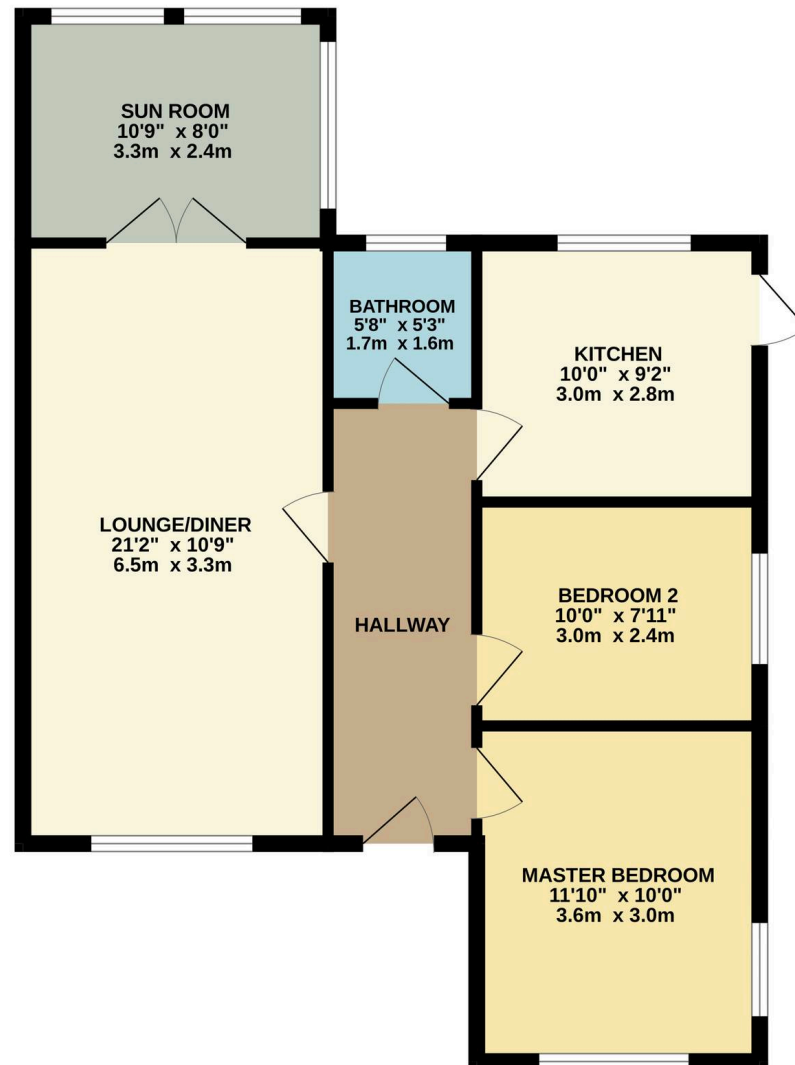

TOTAL FLOOR AREA : 712 sq.ft. (66.2 sq.m.) approx.

Whilst every attempt has been made to ensure the accuracy of the floorplan contained here, measurements of doors, windows, rooms and any other items are approximate and no responsibility is taken for any error, omission or mis-statement. This plan is for illustrative purposes only and should be used as such by any prospective purchaser. The services, systems and appliances shown have not been tested and no guarantee as to their operability or efficiency can be given.
Made with Metropix ©2025

