



11 Schofield Street, Radcliffe

Manchester

£149,950





## 11 Schofield Street

Radcliffe, Manchester

2-bed terraced house in Radcliffe with spacious living area, kitchen/diner, 2 double bedrooms, paved yard. Near transport links. Ideal for first-time buyers or investors.

Council Tax band: A

Tenure: Leasehold

EPC Energy Efficiency Rating: C

EPC Environmental Impact Rating:

- 2 double bedroom Terrace House on a delightful street
- Close proximity to Derby High & St Gabriels High and Bury CE
- Located near Radcliffe Metrolink
- Easy access onto the M66 and A56
- Paved front and rear yard
- 3 piece bathroom suite
- Perfect for First time buyers or an incredible investment opportunity
- Vestibule entrance
- No Onward Chain, Sold with Vacant Possession

GROUND FLOOR

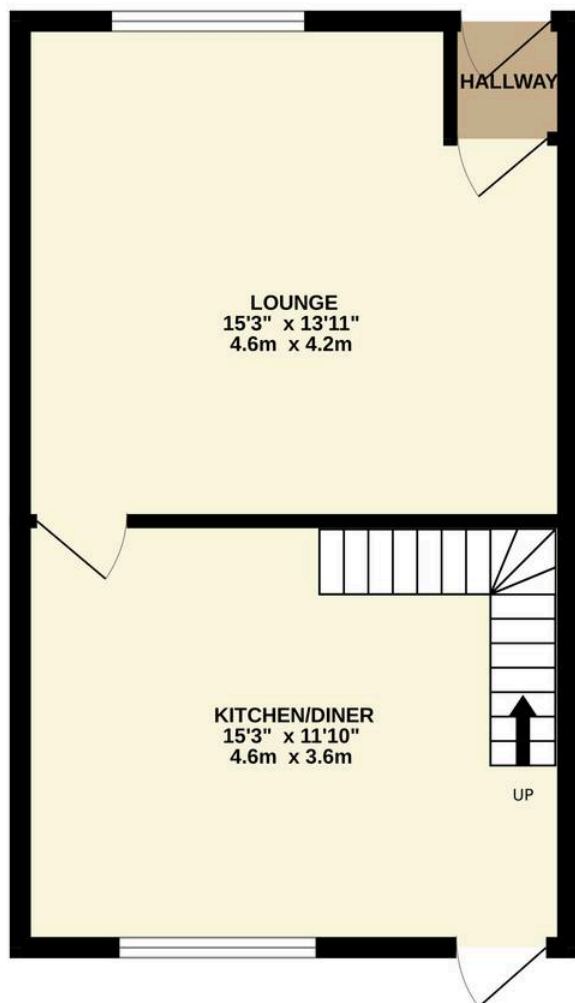

1ST FLOOR

