



12 Sherwood Avenue, Radcliffe

Manchester

£275,000





## 12 Sherwood Avenue

Radcliffe, Manchester

Nestled in the highly sought-after Three Arrows neighbourhood with the picturesque Starling Woods as its backdrop, this 3-bedroom semi-detached house is the ultimate haven for those who appreciate a touch of nature in their every-day lifestyle.

Council Tax band: D

Tenure: Leasehold

EPC Energy Efficiency Rating: D

EPC Environmental Impact Rating:

- - Traditional Semi Detached House with 3 Bedrooms
- - Set in a Highly Desirable Three Arrows location with Starling Woods to the rear
- - Superb Extensive 2 tiered patio and lawn garden with woodland aspect
- - An ideal property for the garden enthusiast
- - Spacious paved driveway, detached garage
- - Entrance hall, fitted kitchen, open plan lounge/dining room
- - Modern Spacious white 4 piece family bathroom suite
- - Close to local bus routes & access for Bury & Bolton town centres
- - Offered with No Chain viewings are Highly Recommended

GROUND FLOOR



1ST FLOOR

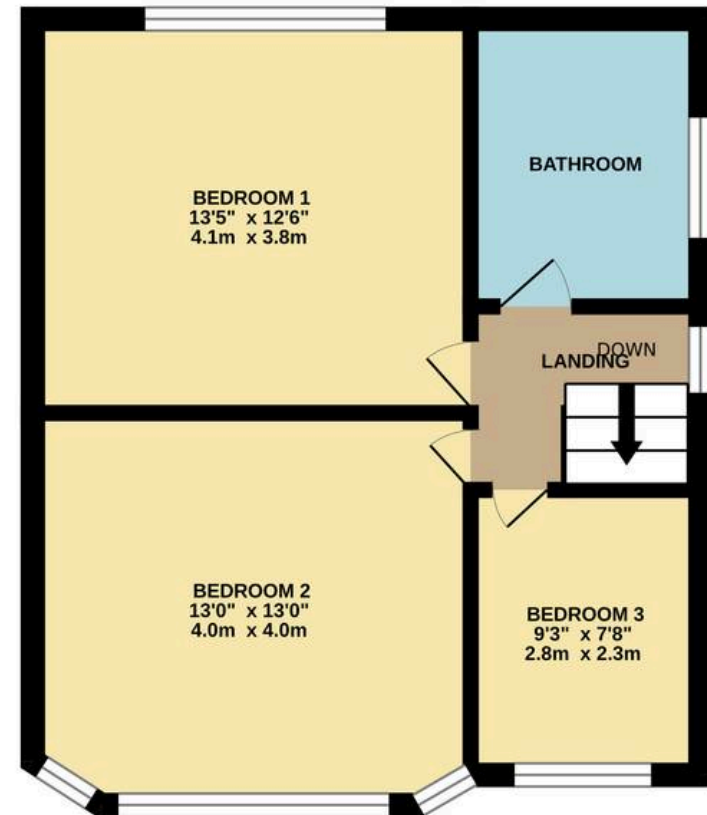





Harrison.  
Est 1987  
FOR SALE  
0161 797 8616

Harrison.  
Est 1987